



GENERAL ASSEMBLER (FULL-TIME, ON-SITE)

To apply, fill out the attached and return completed form via one of the following methods:

- Email to jobs@infiniumwalls.com
- In person at [21000 Infinium Way, Strongsville, OH 44149](#)

INFINIUM Wall Systems is a family-owned turn-key manufacturer of interior Glass Wall Systems headquartered in Strongsville, OH. Founded in 2003, INFINIUM has experienced significant strategic growth fueled by world-class People, Products and Process. INFINIUM has built a great reputation in the industry for saying what we'll do and doing what we say. We are the pioneers of the direct business model which is now adopted by many in the industry.

INFINIUM has the need for a full-time General Assembler that is conscientious, hardworking, and dedicated to join our team with the following:

Responsibilities:

- Assemble wall and door systems, prepare associated materials, and seal various parts for final assembly.
- Read and interpret assembly prints, work instructions, and other technical documents.
- Use hand tools, power tools, and other equipment to assemble final product and components.
- Responsible for aiding in fabrication and construction of our products and other in-house projects.
- Conduct quality inspections and tests to ensure products meet the given specifications and standards.
- Record production data and maintain accurate inventory counts.
- Troubleshoot and solve problems that arise during assembly processes.
- Clean and maintain equipment and work areas.
- Follow safety protocols and always wear appropriate personal protective equipment (PPE).
- Participate in continuous improvement and safety activities to streamline production processes and enhance product quality.

Qualifications:

- Education: high school diploma or equivalent.
- Years of relevant experience: previous experience in a manufacturing environment preferred.
- Familiarity with assembly techniques, tools, and equipment.
- Ability to take direction, read and interpret technical documents, including blueprints and instructions.
- Attention to detail and commitment to quality.
- Good manual dexterity and hand-eye coordination.
- Ability to work independently and as part of a team.
- Good communication and interpersonal skills.
- Willingness to work in a fast-paced and dynamic environment.
- Construction background and manufacturing experience preferred.
- Understanding of assembly techniques, tools, and equipment.
- Ability to identify small details and recognize discrepancies.
- Suitable hand-eye coordination and fine motor skills.
- Ability to communicate effectively and respectfully with other assemblers, supervisors, and quality control personnel; ability to work collaboratively with cross-functional teams.
- Willingness to learn and adapt to new assembly techniques and equipment.
- High-energy, hyper-communicative, conscientious team player and problem solver.

Our company values our employees and offers career growth opportunities for high-performing manufacturing assemblers, providing the opportunity to advance to leadership positions, such as team leaders or supervisors, after gaining experience and demonstrating strong performance. We also offer training programs to enhance technical skills and promote personal development.

The appropriate compensation package will be designed for the right candidate, including health/dental/vision, paid vacation, and 401K plan with a yearly profit-sharing bonus opportunity.

INFINIUM is an equal opportunity employer offering a team-oriented, open, and enjoyable work culture.

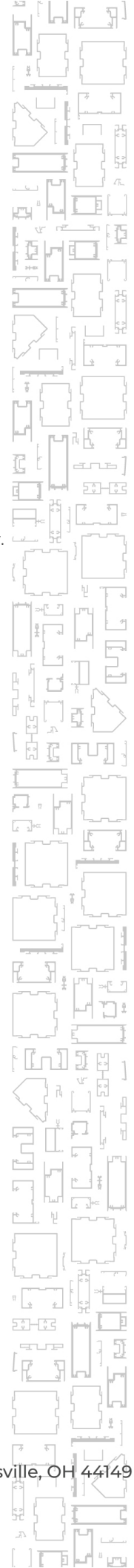

PERSONAL INFORMATION							
LAST		FIRST		MI	EMAIL		
ADDRESS				CITY	ST	ZIP	HOME PHONE
ARE YOU ENTITLED TO WORK IN THE US? <input type="checkbox"/> YES <input type="checkbox"/> NO				ARE YOU 18 YEARS OR OLDER? <input type="checkbox"/> YES <input type="checkbox"/> NO		IF YES, DATE OF BIRTH	
HAVE YOU EVER BEEN CONVICTED OF OR INCARCERATED IN CONNECTION WITH A FELONY IN THE PAST 7 YEARS? <input type="checkbox"/> YES <input type="checkbox"/> NO				IF YES, PLEASE EXPLAIN			
MILITARY SERVICE? <input type="checkbox"/> YES <input type="checkbox"/> NO		IF YES, LIST BRANCH		ARE YOU A VETERAN? <input type="checkbox"/> YES <input type="checkbox"/> NO		IF YES, LIST WAR	
WHAT POSITION ARE YOU APPLYING FOR?				HOW DID YOU HEAR ABOUT THIS POSITION?			
ARE YOU CURRENTLY EMPLOYED? <input type="checkbox"/> YES <input type="checkbox"/> NO		HAVE YOU EVER APPLIED TO INFINIUM BEFORE? <input type="checkbox"/> YES <input type="checkbox"/> NO		DATE AVAILABLE			

WORK EXPERIENCE							
EMPLOYER	CURRENT OR MOST RECENT				PREVIOUS		PREVIOUS
ADDRESS							
CITY STATE ZIP							
PHONE							
NAME OF SUPERVISOR							
DATES OF EMPLOYMENT	FROM	TO	FROM	TO	FROM	TO	
POSITION JOB TITLE							
PAY							
REASON FOR LEAVING							
MAY WE CONTACT?	<input type="checkbox"/> YES <input type="checkbox"/> NO		<input type="checkbox"/> YES <input type="checkbox"/> NO		<input type="checkbox"/> YES <input type="checkbox"/> NO		

EDUCATION							
HS	NAME LOCATION	LAST YEAR COMPLETE				DEGREE	MAJOR EMPHASIS
COLLEGE UNIVERSITY		<input type="checkbox"/> 9	<input type="checkbox"/> 10	<input type="checkbox"/> 11	<input type="checkbox"/> 12		
TRADE SCHOOL		<input type="checkbox"/> 1	<input type="checkbox"/> 2	<input type="checkbox"/> 3	<input type="checkbox"/> 4		
OTHER							
LIST ANY APPLICABLE SPECIAL SKILLS OR TRAINING							

Disclaimer: By signing, I hereby certify that the above information, to the best of my knowledge, is correct. I understand that falsification of this information may prevent me from being hired or lead to my dismissal if hired. I also provide consent for former employers to be contacted regarding work records.

SIGNATURE

DATE